

## STEWARDSHIP REPORT

A report on the impact of giving to cancer at Rush

### Welcome New Cancer Physicians

**Marta Batus, MD** – lung cancer specialist

**Joshua Melson, MD, MPH** – gastrointestinal cancers specialist

**Sunita Nathan, MD** – hematological malignancies, blood and bone marrow transplantation specialist

**Abhitabh Patel, MD** – gastrointestinal cancers specialist

### Major Gifts News

A major commitment from **Nydia and Michael Searle** will fund bioinformatics needs within the cancer program. Bioinformatics is an emerging field that has resulted from an explosion of biomedical information and data. It entails the study of large complex data-bases to extract critical information, speeding scientific discovery and facilitating translational research. For research in the laboratory, clinic and community to realize its full potential and to ensure that we continue to swiftly translate this knowledge into the best quality care for our patients, we must respond to the highly sophisticated informational and statistical requirements of these studies by enhancing our bioinformatics and biostatistics capabilities. The Searle gift will help fund the expertise, techniques, software and hardware that is necessary for Rush's cancer investigators to reach their full potential. Nydia and Michael Searle and other members of the Searle family have made many significant philanthropic contributions to Rush over the years, beginning with ancestor Claude H. Searle, MD, who was an 1898 graduate of Rush Medical College.

At the discretion of its trustees, the **Charles and Margaret Roberts Trust** has supported numerous initiatives at Rush since the 1980s. The late Charles Roberts, a grateful Rush patient, was a proponent of preventive medicine. Recently, Rush was the fortunate beneficiary of a major gift from the Roberts Trust, which will fund a lung cancer research project aimed at developing preventive strategies for a disease that is recognized as the leading cause of cancer death in the world. Principal investigators for the project are James L. Mulshine, MD, vice president and associate provost for research at Rush, and Jordi Tauler, PhD, a research scientist in the Department of Internal Medicine.

**The Gavers Community Cancer Foundation**, founded by cancer survivor Steve Gavers, held its 10th annual barn dance on July 18, 2009. Funds raised through ticket sales, donations, raffles, auctions and sponsorships support cancer programs at a number of organizations, including breast cancer research at Rush. Including funds raised at this year's barn dance, the Foundation has over \$1 million for cancer research. The annual barn dance is open to the public and is held in McHenry County each summer.



For questions about this report, please contact our stewardship office at (312) 942-2836.

As the seven-year, \$300 million capital campaign for Rush University Medical Center enters its final phase, we remain grateful for the extraordinary generosity of our donors. Within the cancer program, our patients and other friends of Rush contributed more than \$18 million toward facilities, research and programs that serve cancer patients. While there is still an urgent need to meet The Coleman Foundation's \$5 million challenge and to complete the facilities portion of our goal, we are pleased to take this opportunity to thank you for your support. There has never been a more exciting time support our cancer program and to express our appreciation for your commitment to Rush. This report is intended to bring you up to date on the scope and impact of giving to the cancer program. You have our sincerest thanks.

### Outpatient Cancer Center Update

A major priority in the capital campaign's support of cancer care is the expansion and relocation of the outpatient cancer center. Philanthropic gifts will partially cover the costs of establishing a new center, which will span the entire 10th floor of the professional building, tripling the size of Rush's current outpatient cancer facilities. Construction begins in the late fall of 2009 with occupancy scheduled for the fall of 2010.

The principles guiding the concurrent construction of Rush's new hospital building also guide the cancer center project. The new center will reflect Rush's focus on quality of care and the patient experience while promoting optimal outcomes. Standardization and sustainable ("green") design were factored into the plans, along with the integration of technology, research and education.

Eight comprehensive clinics housed in the center will expand to accommodate more cancer specialists, providing optimum space to confer with one another and with patients and family members. (See the Coleman Challenge update for more about the clinics.) The Rosemarie and Dean Buntrock Infusion Center will include 56 infusion chairs for chemotherapy, 20 more chairs than Rush currently has available. A women's cancers suite within the center is designed for the special needs of breast cancer and gynecological oncology patients, while one of three procedure rooms will be outfitted especially for bone marrow biopsies.

This project will also expand the space available to Rush's integrative medicine program, which provides complementary services and psychosocial counseling

to promote patients' sense of well-being and maintain their quality of life. Support services, such as the Patient Navigator Service, which is run in collaboration with the American Cancer Society, will have more space and resources to work with patients and families on participation in clinical trials and concerns such as prosthetics and transportation. A resource center will allow waiting patients and families to access information about cancer through publications and the internet. An art therapy room will allow space for patients to express their creativity while providing a distraction as they undergo treatment.

An increase of exam rooms from 24 to 41 and expanded pharmacy capacity will minimize wait times even as patient volume increases. The overall goal of the center is to make life easier for patients while also enabling more collaboration among their medical team — a key element of optimal care.

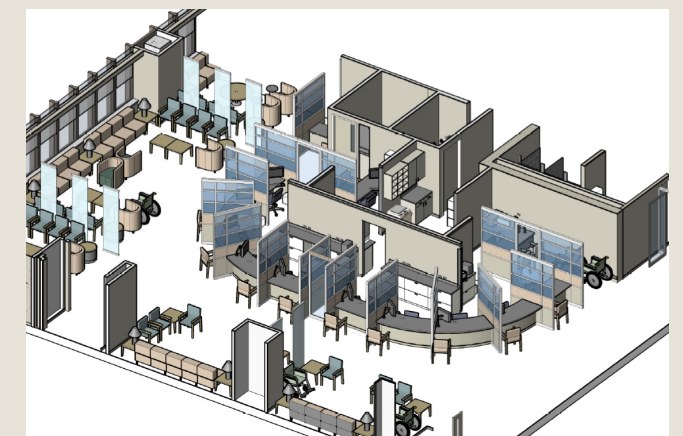

Main waiting area of outpatient cancer center

## Coleman Challenge Update

The Coleman Foundation, a longtime supporter of cancer care at Rush, has issued a \$5 million matching challenge grant in support of the expansion and relocation of the outpatient cancer center. This is an extraordinary opportunity for donors to double the value of their gift.

In recognition of this gift, the largest in the foundation's history, the comprehensive cancer clinics located in the cancer center have been recognized as The Coleman Foundation Comprehensive Cancer Clinics. Currently located within Rush's existing cancer center, the clinics for breast cancer, head and neck cancers, lung cancer, pigmented lesions, prostate cancer, multiple myeloma, and gastrointestinal cancers will be expanded and relocated within the new outpatient cancer center, with space reserved for a brain cancer clinic and other clinics planned for the future. The unique structure of these clinics brings together teams of oncologists, radiologists, surgeons, nurse practitioners, case managers and other cancer experts to plan each patient's course of treatment collectively. Donors who support this effort will be founding a destination for cancer patients seeking the most comprehensive, team-based care.

The Coleman Foundation's commitment is extraordinary, but the overall \$10 million goal reflects a group effort. We are grateful to the many individual and organizational donors who have supported the Coleman Foundation Challenge by making gifts toward the \$5 million challenge portion. To date, more than 400 donors have committed more than \$2 million toward the goal. With an end date for the challenge of June 30, 2011, securing gifts of all sizes for this purpose is critical.

If you are interested in joining the Coleman Foundation Challenge, please contact Lynne Considine Nieman at (312) 563-4219.

### \$10 Million Initiative — Coleman Challenge

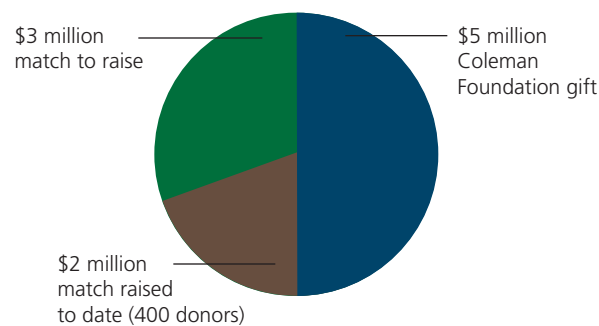

## Rush Rounds

Rush Rounds is a series of in-depth discussions hosted by our Leadership Committees about health care innovations in specific disease areas at Rush University Medical Center. With fall and spring series planned for topics in cancer, orthopedics, heart and vascular medicine and neuroscience, guests have the opportunity to hear presentations from Rush experts and ask questions in a setting that is only available for Rush insiders. The Leadership Committee for the Rush Cancer Institute hosted Preventing and Treating Men's Cancers: What You Need to Know in October. A panel discussion featured Rush President and CEO Larry Goodman, MD, colon and rectal surgeon Theodore J. Saclarides, MD, and urologist Christopher L. Coogan, MD. If you are interested in hearing about the next topic in cancer or other topics, please contact Lynne Considine Nieman at (312) 563-4219.

## Cancer Center Program Director Named

**Howard L. Kaufman, MD**, joined the Medical Center in the role of Rush Cancer Program director and associate dean on October 1. Dr. Kaufman came to Rush from Columbia University, where he was chief of the Division of Surgical Oncology and director of the Columbia Melanoma Center. He previously served a term as associate director of the Herbert Irving Comprehensive Cancer Center at Columbia and chaired the Oncology Service Line at The New York Presbyterian Hospital. Dr. Kaufman completed fellowships in tumor immunology and surgical oncology at the National Cancer Institute. His current primary research interest is in tumor vaccines and cancer immunotherapy. Dr. Kaufman has extensive experience on editorial boards and has sat on nearly two dozen review and study sections. He has published more than 120 manuscripts, books and chapters.

As program director, Dr. Kaufman is responsible for the strategic planning process and execution, and leads the development and refinement of our cancer service line across the components of the Rush mission. As the key partner in shaping the direction of Rush's cancer program, he will spend much of his effort coordinating collaboration and programmatic growth among the various areas of cancer care and their leaders.

## Recent Accolades

**Rush University Medical Center's cancer program was awarded** a 2008 Outstanding Achievement Award from the American College of Surgeons Commission on Cancer (CoC). The award recognizes excellence in providing quality care to cancer patients. Rush is one of only 95 cancer programs nationwide to receive the award and is one of just a few programs to receive the triennial award twice since its 2004 inception. Programs that receive the award must demonstrate a high level of compliance to seven key standards, including leadership, data management, clinical services, research, community outreach and quality improvement, while also being rated for compliance to 29 additional program standards. Under 20 percent of those programs surveyed received the award.

**For the third consecutive year, Rush University Medical Center has been ranked** among the five top performing academic medical centers in the country in the University HealthSystem Consortium (UHC) Quality and Accountability Study. Rush has been ranked as a top performer every year since the study's inception in 2005.

**The 2009 study** evaluated 93 academic medical centers on the basis of mortality, timeliness, effectiveness, efficiency, equity of care and patient centeredness. For the fifth year in a row, Rush attained a perfect score in the equity of care category, which measures whether patient outcomes differ due to gender, race or socioeconomic status. This showing is a credit to all of Rush's clinical services, including the multidisciplinary cancer program.



## Janet M. Wolter, MD, Retires

This fall, one of Rush's premier cancer specialists will retire after 45 years at the Medical Center. Janet M. Wolter, MD, a nationally respected medical oncologist, has been the Brian Piccolo Professor for Cancer Research since 1996 and the principal investigator for the Rush arm of the National Surgical Adjuvant Breast and Bowel Project (NSABP)\* since 1989.

After receiving her medical degree from the University of Illinois, Dr. Wolter completed training at Johns Hopkins Hospital, Duke University Hospital and the University of Illinois. She joined the staff of Rush's predecessor institution, Presbyterian-St. Luke's Hospital, in 1963 to collaborate with Dr. Samuel G. Taylor III in his pioneering work treating cancer patients with hormones and chemotherapy. While her early experience included all kinds of cancer, Dr. Wolter's primary focus has been breast cancer, an interest that ultimately led to her role in Rush opening the first comprehensive breast center in the Midwest.

In recognition of Dr. Wolter's groundbreaking contributions in translational research and her commitment to her patients, the Janet M. Wolter, MD, Conference Center will be established within The Coleman Foundation Comprehensive Clinics area of the new outpatient cancer center. Colleagues, former students, patients and family members are invited to be part of this effort by making a gift in honor of Dr. Wolter to support the expansion of the cancer center. All gifts will be matched by The Coleman Foundation. Please contact Lynne Considine Nieman in the Office of Philanthropy at (312) 563-4219 if you would like to be a part of this tribute to Dr. Wolter.

\* The NSABP is a clinical trials cooperative group supported by the National Cancer Institute (NCI), with a 50-year history of designing and conducting clinical trials that have changed the way breast cancer is treated and prevented.



Janet Wolter